



PRESBYTERIAN
SENIOR LIVING
Silver Spring Gardens

*Affordable Apartment Living
for Those Age 62 and Older*



MECHANICSBURG, PA

Discover Silver Spring Gardens

Each energy-efficient apartment includes:

- Well-equipped kitchen
- Individually controlled heating and central air conditioning
- Smoke alarms
- Mini blinds are provided
- Pre-wired for phone and cable TV

Additional features include:

- On-site laundry facilities
- Pet friendly
- Community Room
- Tobacco- and smoke-free community
- Resident services coordination

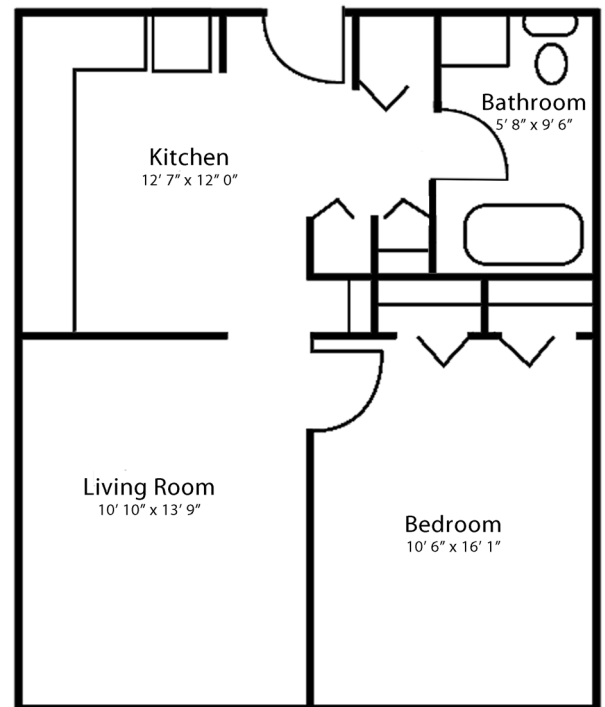

One Bedroom 568 sq. ft.

We offer one-bedroom and two-bedroom floor plans. These are sample layouts for our apartments. We also have accessible apartments for those with mobility and/or hearing/vision impairments.

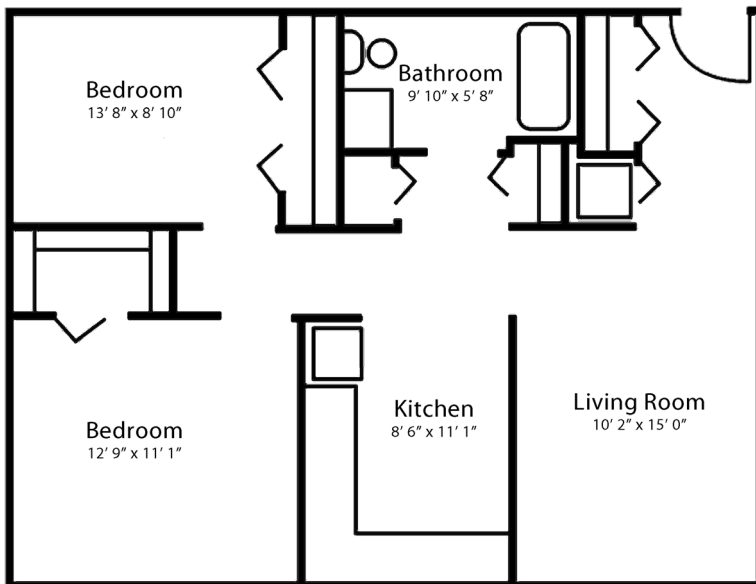

Two Bedroom 773 sq. ft.

Frequently Asked Questions

- ***Where is the community?***

Silver Spring Gardens is located on Ashburg Drive, right off of the Carlisle Pike, adjacent to the Cumberland Valley Educational Park in Mechanicsburg, PA 17050. The community is near to Interstate 81 between Carlisle and Harrisburg, PA.

- ***How is income and rent eligibility determined?***

Rent and income limits have been established under federal program guidelines based on household size. Qualifying income limits and rents are adjusted annually. Housing Choice and VASH Vouchers are accepted.

Please Note: Apartments within the community have different income limits. An applicant's income-eligibility must be determined as it relates to an available apartment. If an applicant does not meet the income requirements for a particular available apartment, they may retain their current place on the waiting list as long as their household income is not less than the minimum or more than the maximum income limits for the community.

- ***Special rules regarding student households.***

Due to IRS restrictions, households in this community may not be made up entirely of full-time students unless certain conditions are met. Please ask us for further details.

- ***How much is the security deposit and application fee?***

The security deposit is equal to one month's rent. There is a small non-refundable application fee per applicant.

- ***Are any utilities included in the rent?***

YES! Rent includes water, sewer, trash and all electric including heat and air conditioning. You can take comfort in the fact that you'll know what your living expenses will be each month.

- ***Can I have a pet?***

Some pets are permitted, including dogs and cats. Please contact the Community Manager for further information. An additional pet deposit and monthly pet fee will apply. Pets must be properly licensed and immunized and kept indoors unless they are on a leash and accompanied by their owner.

- ***Is there storage?***

Each apartment home has a large closet in the kitchen, a linen closet, and in each bedroom. Most bathrooms have a vanity and there is ample cabinet and counter space in the kitchens.

Frequently Asked Questions

- ***What will it be like living at Silver Spring Gardens?***

There is plenty to stay occupied at Silver Spring Gardens! Residents can enjoy a quiet moment sitting on one of the patio benches or meet up with friends and neighbors in our spacious Community Room. The Resident Services Coordinator is available to help residents find services they may need. The Community Room has a television and many activities are held there. Examples of activities include monthly meetings, potluck dinners, movie or game nights, music night, speakers and resources, and theme parties around the holidays, as well as health and wellness programs. A hair salon with hair sink and hair dryer is the ideal place to cut and style your hair. The Fitness Center will keep you in shape. Get a little bored on a treadmill? The Fitness Center has TV that you can enjoy while walking your way to fitness.

- ***What about laundry facilities?***

The laundry room features card-operated washers and dryers. With its comfortable seating and TV, it's an ideal place to relax or meet friends.

- ***Is there a meal service?***

Meals on Wheels will provide home-delivered meals to eligible residents. Residents may also take advantage of the luncheon program provided at the Mechanicsburg Senior Center.

- ***Sounds great! How do I apply?***

Applications are available at the community, may be downloaded and printed from www.silverspringgardens.org or you may request an application be mailed to you.

If you speak limited English and need an interpreter, please contact the Management Office and one will be provided free of charge.

If you or a member of your household has a disability and requires a reasonable accommodation, you may request it at any time during the application process.



Our Mission

Guided by the life and teachings of Jesus, the mission of Presbyterian Senior Living is to provide compassionate, vibrant and supportive communities and services to promote wholeness of body, mind and spirit.

About Presbyterian Senior Living

Founded in 1927 and based in Dillsburg, PA, Presbyterian Senior Living is one of the largest not-for-profit providers of senior housing in the country. More information about Presbyterian Senior Living can be found on the website www.psl.org.



PRESBYTERIAN
SENIOR LIVING
Silver Spring Gardens

66 Ashburg Drive • Mechanicsburg, PA 17050
717-591-1918 • TTY #711 • www.silverspringgardens.org

It is our policy to admit residents without regard to race, color, religion, sex, handicap or national origin and any other federal, state or local fair housing protections. Note: Housing for Older Persons is exempt from the prohibitions against age or familial status.



Silver Spring Gardens Rate Sheet

Rental community for those age 62 or older

Rates are subject to change.

Rental Rates

Bedroom Size	Unit Set-aside ⁽²⁾	Minimum Income ⁽³⁾	Maximum Income (1 Person)	Maximum Income (2 People)	Monthly Rent Amount
1	40%	\$19,680	\$30,640	\$35,000	\$820
1	50%	\$24,600	\$38,300	\$43,750	\$1,025
1	60%	\$24,600	\$45,960	\$52,500	\$1,025
2	50%	\$29,520	\$38,300	\$43,750	\$1,230
2	60%	\$29,520	\$45,960	\$52,500	\$1,230

Mobility and Hearing/Vision Accessible Apartments

Bedroom Size	Special Apartment Features ⁽¹⁾	Unit Set-aside ⁽²⁾	Minimum Income ⁽³⁾	Maximum Income (1 Person)	Maximum Income (2 People)	Monthly Rent Amount
1	Mobility, Hearing/Vision	50%	\$24,600	\$38,300	\$43,750	\$1,025
1	Mobility, Hearing/Vision	60%	\$24,600	\$45,960	\$52,500	\$1,025
2	Mobility, Hearing/Vision	50%	\$29,520	\$38,300	\$43,750	\$1,230

Rent Includes:

Geothermal heat, electric, water, sewer and trash removal

1. In order to be eligible for an apartment with accessible features, you must require the features of the apartment.
2. This apartment community participates in the federal low-income housing tax credit program and claims tax credits in return for renting some or all of the apartments to low-income tenants at a restricted rent based on area median income, a measure used to determine housing affordability. Income limits are available for larger households upon request. This community does not give out waiting list numbers because applicants may qualify for several unit set-asides based on their income. When an apartment becomes available, applicants are selected by date and time order of their waiting list application to determine if they are interested in the available apartment at the designated rent. Applicants who qualify for multiple income set-asides may specify that they only want to be contacted for the lowest set-aside for which they would qualify. Note: "Unit set-aside" is the percentage of where your income falls in relation to area median income for the county where this community is located; it does not mean that you will pay 50% of your income for housing.
3. Minimum incomes are determined to ensure that residents do not pay more than 50% of their income for housing expenses. There is no minimum income requirement for holders of Housing Choice or VASH rental assistance vouchers.

Contacte a la comunidad par asistencia linguistica.

It is our policy to admit residents without regard to race, color, religion, sex, handicap or national origin and any other federal, state or local fair housing protections. Note: Housing for Older Persons is exempt from the prohibitions against age or familial status.



*Revised 6/1/2026